

POCKET DOOR EZ-CLOSER INSTALLATION INSTRUCTIONS

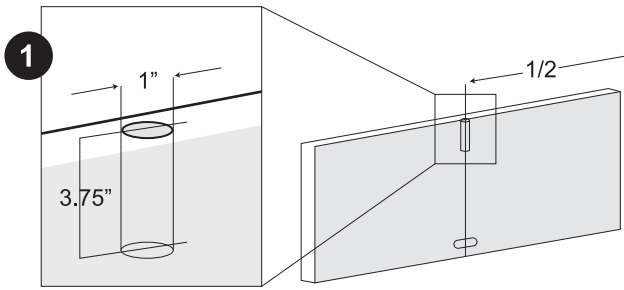

Flush Doors: With the door dismantled, measure and find the **centre on the back edge of the door**.

IMPORTANT: For doors with glass, molded passages or any other non-flush door you might need to off-set the location of the hole for installation of the *EZ-Closer*. Before drilling ensure that there is sufficient width and depth to drill a 1.0 inch wide hole 3.75 inches deep without damaging the door. See installation tips 1 and 2, below.

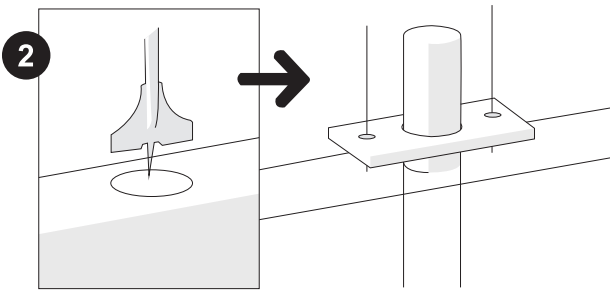

Using a **1 inch spade bit**, bore a hold to the depth of **3.75 inches** (the length of the *EZ-Closer* cylinder.) Firmly push the *EZ-Closer* into the drilled hole and secure with the two screws provided (screws must be counter sunk). Now your door is ready to be fitted.

On particularly narrow doors with minimal clearances, an alternative option would be to drill a $7/8$ " hole and use a round rasp to cut some extra clearance for the guide screw. As per option B drawing.

The *EZ-Closer* should sit on the back edge of the door. **DO NOT** mortise the flange into the back of the door.

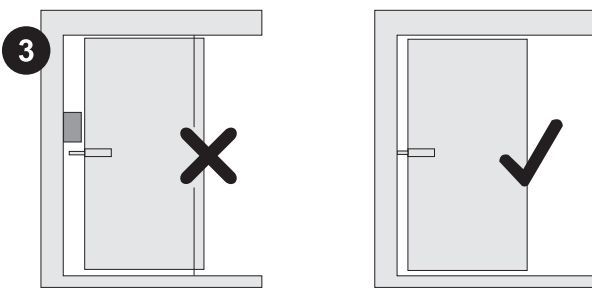
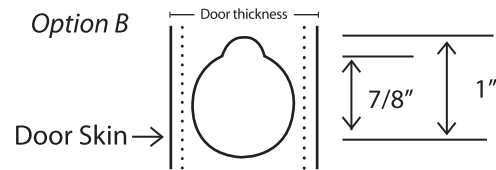

Ensure that there is **no object between the back of the door** and the back stud inside the pocket, which would prohibit the plunger on the *EZ-Closer* from being fully depressed (see diagram). The pocket back stud and back edge of door must be plumb allowing the gap between door and back stud to be parallel.

Pocket Doors with the *EZ-Closer* installed **do not need the bumper** (remove the bumper at the end of cavity if already installed).

DO NOT adjust body screw, this is a guide screw preset in the manufacturing process.

PHYSICAL SPECIFICATIONS

Weight: 2 oz.

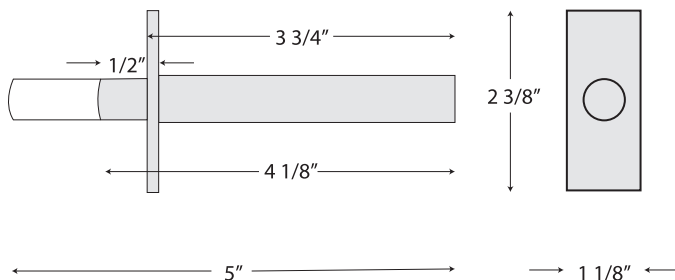

INSTALLATION TIPS

- 1) For smooth operation do not install the *EZ-Closer* near the top or bottom edge of the door. The door must NOT tilt when pushed to release from the cavity.
- 2) For non-flush doors an alternative installation option is to install the *EZ-Closer* in the pocket back stud.
- 3) If the door is slightly undersize in relation to the pocket, place enough washers (packers) between the *EZ-Closer* faceplate and the back edge of the door, until the front edge of the door is flush with the opening jambs.



JEXIS CAVITY SLIDER DOOR RELEASE PRODUCT SPECIFICATION



FOR FURTHER INFORMATION AND
SAMPLES CONTACT

PC Doors, LLC

355 Goddard, suite 250
Irvine, CA 92618
(949) 468-0178

www.pcddoors.com

Quick, Simple and Easy

Product Performance

The Jexis body and plunger is glass fibre reinforced injection moulded (PA6 GFR PA6).

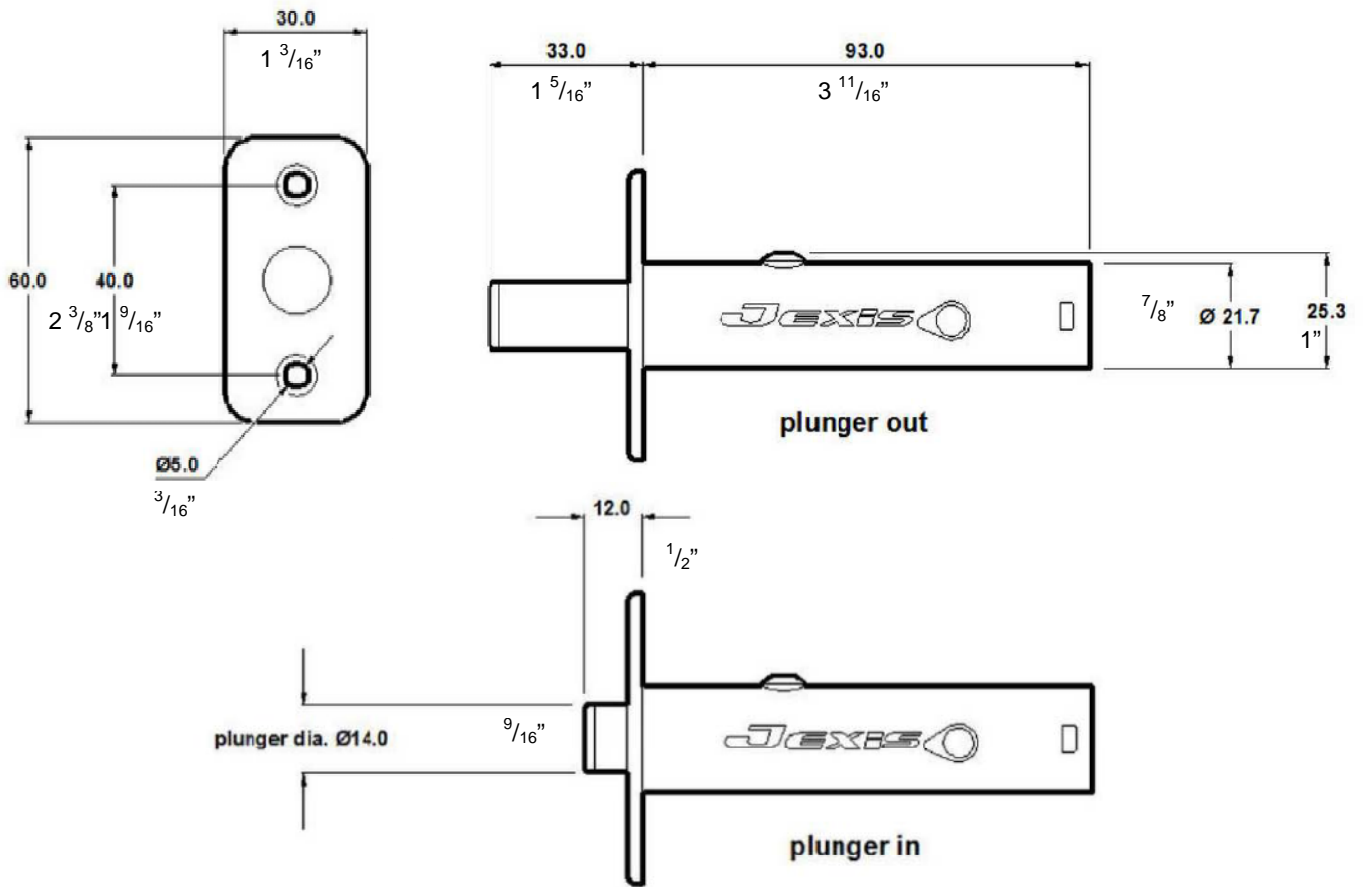

Internal Directional Mechanism

Patented technology powered by right hand helix spring

Material: EN 10270 Ptl Patented Carbon

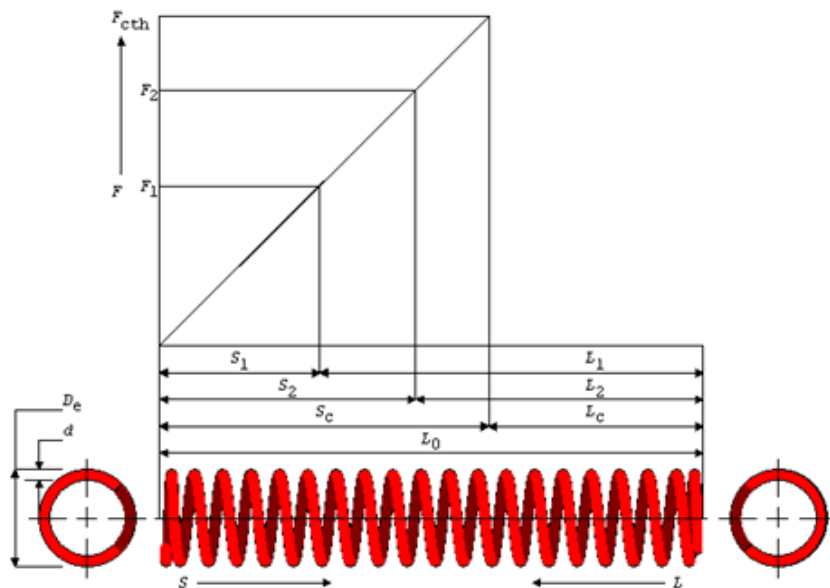

Installation

Installing a Jexis on cavity sliding doors is simple, quick and easy. The average installation time is less than two minutes and the only tool needed is a drill, two bits and a couple of screws. No routing, no chiseling, no mess, no fuss. The mechanism is spring loaded and fitted to the back edge of the door by drilling a clearance hole into the door and fastened by two screws through the faceplate. This will allow the plunger shaft to eject out of the door and strike the aluminium back stay of the cavity slider pocket propelling the door outward by approximately 300mm. Alternatively, the Jexis can be mounted through the aluminium backstay allowing the plunger shaft to strike the back edge of the door propelling it forward.

Pre-Hanger Fitting Instructions

1. With the back edge of the door facing you, measure and find height & centre eg: all doors = 1200mm up from bottom of door then find centre of door. A 38mm thick door = 19mm. Mark the door using a 25mm speed bore bit drill a hole to the depth of 100mm. As per option drawing A.

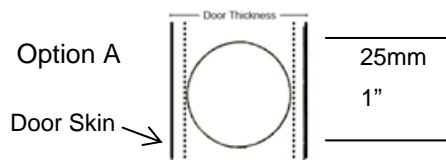

2. On particularly narrow doors with minimal clearances, an alternative option would be to drill a 22mm hole and use a round rasp to cut some extra clearance. As per option drawing B.

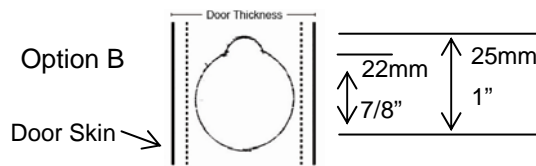

3. Place Jexis Cavity Release in the drilled hole and secure with 2 x screws. Now your door is ready to be fitted.

Handy Hints:

- A. Allow a clearance of 12mm or half an inch between the back edge of the door and the backstay (vertical component) of the cavity pocket.
- B. If the door is slightly undersize in relation to the pocket. Place enough washers (packers) between the Jexis faceplate and the back edge of the door until the front edge of the door is flush with the opening Jamb.
- C. Alternatives if door is too wide buzz to required width.

DO NOT

1. Check face plate into doors edge as this may impede the loading and release cycle of the Jexis plunger.
2. Adjust body screw, this is a guide screw only preset in the manufacturing process.

Builders Cavity Fitting Instructions (Installer)

1. N.B. Backstay of Cavity opposite the Jexis in door to have no screw fixings. Screw backstay to framing away from the release mechanism area.
2. Cavity back stud and back edge of door must be plumb allowing the gap between door and back stud to be parallel and clear of any foreign objects.

Failure to do this could affect the smooth and positive feel of the Jexis action.

Handy Hints

- A. There must be no excessive high spots between the back edge of the door and aluminum backstay that might impede the loading and release cycle of the Jexis plunger.
(A recommended option is to fix the backstay by screwing through the nog channels of the aluminum backstay clear of the back edge of the door.)
- B. These instructions refer to an assembled cavity slider all made up ready to fit in the trimmed hole. The aluminum backstay referred to is the back vertical component that forms part of the structural cavity frame.
- C. If the cavity slider is to be built in position allow a clearance of 12mm or half an inch between the back edge of the door and the stud or surface contact area for the Jexis plunger.

Transportation of Cavity Sliders fitted with the Jexis

On the backstay of the cavity pocket it is essential to put temporary packers between the back edge of the door and the inside of the backstay. This is to stop the door bouncing up and down on the Jexis during transport which would damage the internal mechanism.

Failure to follow the above conditions will void any warranty claim.

IMPORTANT

Before installation of the Cavity pocket, the temporary packer blocks must be removed as they would interfere with the operation of the Jexis.

